



SHOWCASE NATURE STRIP PROJECT 2021/22



Dover St, Flemington - Planter Boxes for Edible Plants

Project Summary

The *Showcase Project* is an initiative of *Strips of Nature Moonee Valley*, generously supported by *Moonee Valley City Council & Moonee Valley Sustainability*.

Our aim was to support local residents to create nature strip gardens by providing resources to plan, prepare & plant their nature strips.

All gardens are compliant with the *Moonee Valley Nature Strip Landscaping Policy 2018* and were granted a permit by Council.

Design

The aim was to create community planter boxes where passers by can take cuttings for personal use.

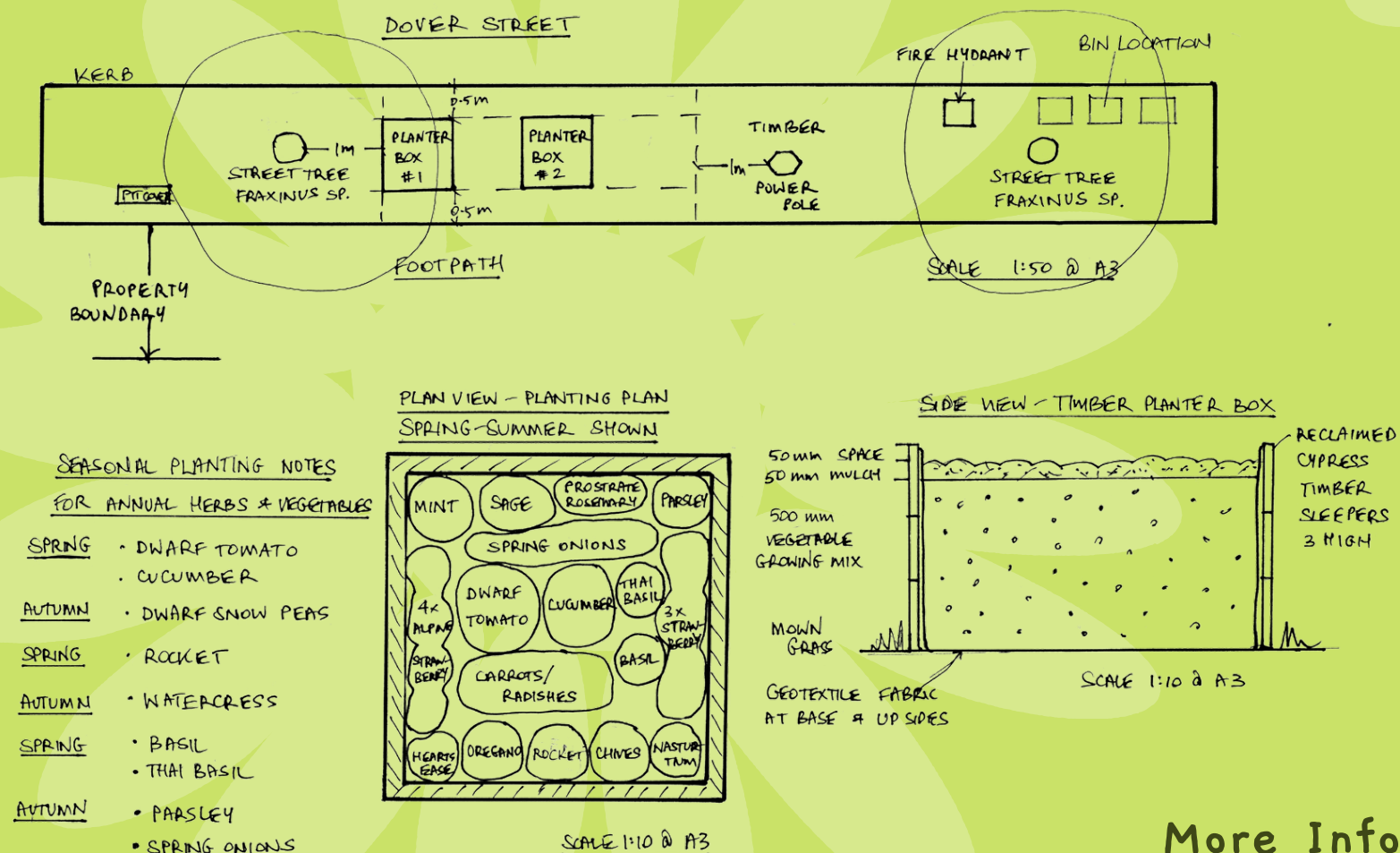

Plants - Edibles for sun

- Spinach
- Silverbeet & chard
- Kale (many types)
- Spring onions
- Leeks
- Onions
- Beetroot
- Carrots
- Radish
- Chives
- Celery
- Cucumber
- Dwarf snow peas
- Dwarf tomatoes
- Basil
- Thai basil
- Mint
- Rocket
- Sage
- Rosemary
- Land cress
- Watercress
- Leafy lettuces
- Coriander
- Thyme
- Pizza thyme
- Oregano
- Marjoram
- Strawberries
- Calendula
- Nasturtium

Edibles for shade

- Perpetual spinach
- Kale (many types)
- Spring onions
- Leeks
- Celery
- Flat leaf parsley
- Mitsuba (Japanese parsley)
- French (lemon) sorrel
- Red-ribbed chicory
- Leafy lettuces
- Coriander
- Lemon thyme
- Alpine strawberry
- Rhubarb
- Violas
- Pansies

Suppliers

Mount Coburg - custom Macrocarpa Cypress planter boxes
www.mountcoburg.com.au

Soilworx - veggie soil mix
www.soilworx.com.au

CERES Nursery - seedlings, plants
www.ceres.org.au

Bunnings - compost, manure, mulch
www.bunnings.com.au

Designer

Karen Sutherland from Edible Eden Design has over 25 years experience teaching and helping to create beautiful and edible nature strip gardens.
www.edibleeden.com.au



More Info

Scan QR to Moonee Valley Sustainability webpage or email to stripsofnaturemv@gmail.com





SHOWCASE NATURE STRIP PROJECT 2021/22

Duncan St, Flemington - Flowers and Succulents



Project Summary

The *Showcase Project* is an initiative of *Strips of Nature Moonee Valley*, generously supported by *Moonee Valley City Council & Moonee Valley Sustainability*.

Our aim was to support local residents to create nature strip gardens by providing resources to plan, prepare & plant their nature strips.

All gardens are compliant with the *Moonee Valley Nature Strip Landscaping Policy 2018* and were granted a permit by Council.

Design

The aim was to create a colourful garden that is an asset to the streetscape, to promote biodiversity and to provide inspiration to others to plant out their own nature strip.

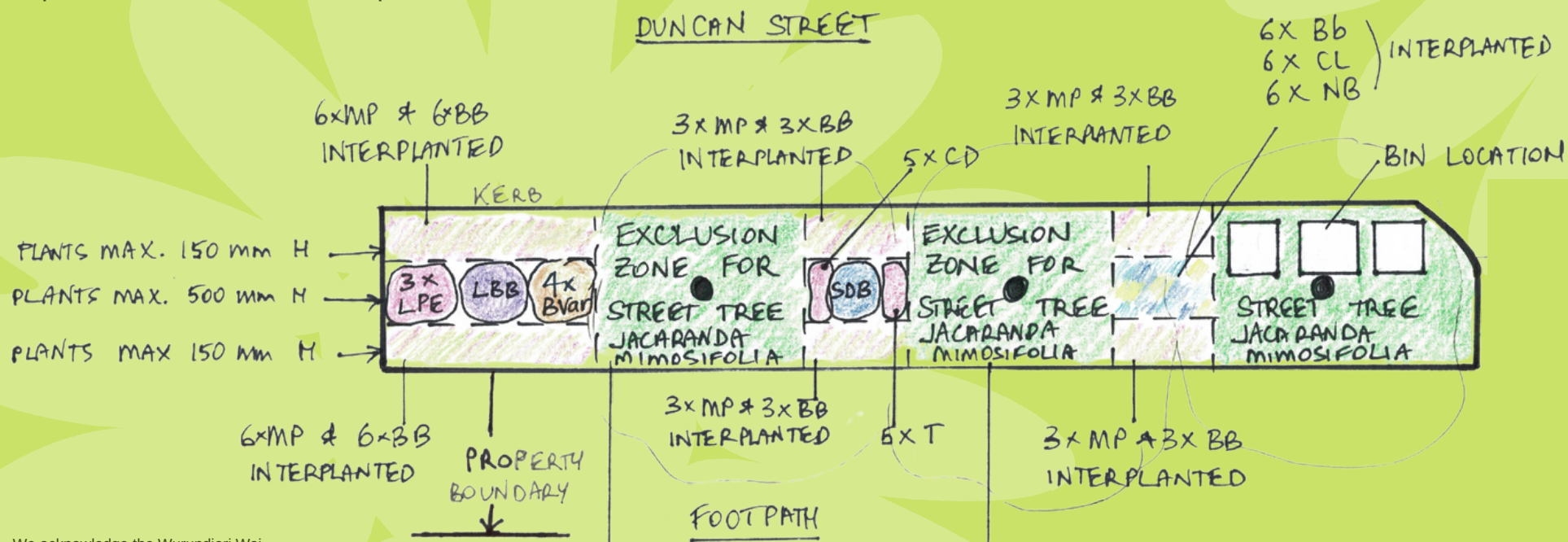

We acknowledge the Wurundjeri Woi Wurrung people as the Traditional Custodians of the Country on which this nature strip is located, and we pay our respects to their elders and community members past and present.

Designer

Karen Sutherland from Edible Eden Design has over 25 years experience teaching and helping to create beautiful and edible nature strip gardens.



Plants

The plants used were a mixture of hardy flowers and succulents with a maximum growing height of 50cm including:

- Armeria 'Bees Ruby'
- Salvia 'Vivacious Fisher'
- Lavandula Hidcote
- Chrysocephalum 'Desert Flame'
- Dianthus (various)
- Bracteantha 'Elite Citrine'
- Mini pig face (Mesembryanthemum)
- Sweet Alyssum

Suppliers

Poyntons Nursery
plants
www.poyntonsnursery.com.au

MVCC Transfer Station
mulch
www.mvcc.vic.gov.au

Edible Eden Design
design / project expert / advisor
www.edibleeden.com.au



More Info

To learn more or connect with us, scan the QR code to go to Moonee Valley Sustainability's 'Strips of Nature' webpage or email us at stripsofnaturemv@gmail.com





SHOWCASE NATURE STRIP PROJECT 2021/22

Mark St, Keilor East - Healing Country Indigenous Planting



Project Summary

The Showcase Project is an initiative of Strips of Nature Moonee Valley, generously supported by Moonee Valley City Council & Moonee Valley Sustainability.

Our aim was to support local residents to create nature strip gardens by providing resources to plan, prepare & plant their nature strips.

All gardens are compliant with the Moonee Valley Nature Strip Landscaping Policy 2018 and were granted a permit by Council.

Plants

The plants selected are mostly indigenous to Moonee Valley:

- Ruby Saltbush (Enchylaena Tomentosa)
- Winter Delight (Grevillea Lanigera)
- Swamp daisy (Brachyscome Basaltica)
- Creeping Boobialla (Myoporum Parvifolium)
- Spreading Flax-Lily (Dianella Admixta)
- Small Vanilla Lily (Arthropodium Minus)
- Lemon Beauty-Heads (Calocephalus Citreus)
- Common Everlasting (Chrysocephalum Apiculatum)
- Golden Billy Buttons (Pycnosorus Chrysanthes)

Design

The aim was to heal Country by planting locally indigenous species, providing habitat, reducing pollution and cooling the area and to heal Country by acknowledging and paying our respects to the traditional custodians of this area.

Designer

Logan Shield from Geometrica has been passionate about plants from an early age and has since gained knowledge in many areas of sustainability.



Suppliers

Newport Lakes Native Nursery - plants
www.facebook.com/NewportLakesNativeNursery/

ecoDynamics - plants
www.ecodynamics.com.au/

MVCC Transfer Station - mulch
www.mvcc.vic.gov.au

Geometrica - design / project expert
www.geometrica.com.au

We acknowledge the Wurundjeri Woi Wurrung people as the Traditional Custodians of the Country on which this nature strip is located, and we pay our respects to their elders and community members past and present.

More Info



Scan QR to Moonee Valley Sustainability webpage or email to stripsofnaturemv@gmail.com



'HEALING COUNTRY' NATURE STRIP PLANTING

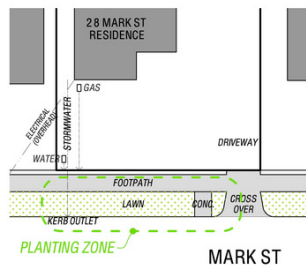

EXISTING PLAN 1:250

PLANTING KEY

COMMON NAME	BOTANICAL NAME	MATURE H x W	No.
LOW PLANTING			
Creeping Boobialla	Myoporum Parvifolium	0.1 x 0.5m	42
MEDIUM PLANTING			
Tufted Bluebell	Wahlenbergia Communis	0.5 x 0.5m	8
Winter Delight	Grevillea lanigera x lavandulacea	0.4 x 1.0m	7
Lemon Beauty-Heads	Calocephalus Citreus	0.5 x 0.5m	8
Hoary Sunray	Leucocorysum Albicans	0.5 x 0.5m	1
Spreading Flax-Lily	Dianella Admixta	0.5 x 0.7m	5
MULCH			
		2.4m ² of planting @ 50mm deep = 1.2m ³	



Deconstructing the Land, the Red River, Marlene Young (1999)

SERVICES

- ELECTRICITY - 0 HEAD SHOWN
- GAS - METER SHOWN
- WATER - METER SHOWN
- SEWER - N/A
- DRAINAGE - HERB OULET SHOWN
- TELECOMMS - N/A
- SIGNS - N/A
- OTHER - N/A

GENERAL NOTES

- All works in accordance with Moonee Valley Nature Strip Landscaping Policy
- Excavation by hand only to max. 150mm deep
- Planting to be mulched during establishment & contained within nature strip & flush with footpath & kerb at all times
- No chemicals / poisons to be used

DESIGN STORY

- The site is a few hundred metres from Steele Creek, a much loved, but threatened, urban waterway.
- The creek and surrounding catchment area hold great significance to the Wurundjeri Woi-wurrung people, who relied on it for fishing, transport and food.
- Development has had a hugely detrimental impact on the people, plants and animals of the area, removing almost everything that once existed here.
- This artwork, "Deconstructing the Land, the Red River" by Marlene Young about the Marybysing River, which Steele Creek flows into, tells some of this complex story.
- Various groups of people, campsites, animal tracks and eel traps can be seen, as well as blood and pollution.
- The nature strip design aims to heal Country in a practical way by planting locally indigenous species, providing habitat, reducing pollution and cooling the area.
- The project also aims to heal Country by acknowledging and paying our respects to the traditional custodians of this area.

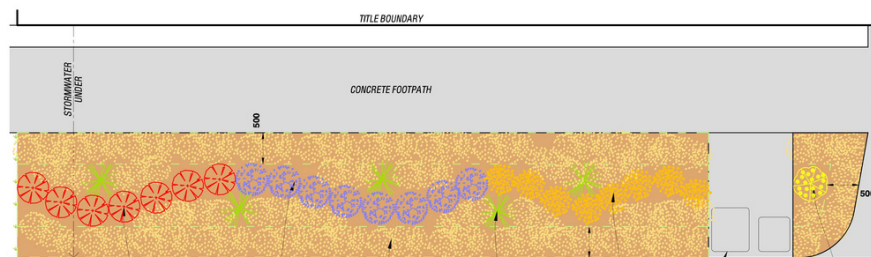

PROPOSED PLAN 1:50